













ELECTRICAL LEGEND		
Symbol	Description	HEIGHT OF FFL.
	2X28W T-5 LIGHT FIXTURE	CEILING
	3X14W T-5 LIGHT FIXTURE	CEILING
	2NOS.DATA AND 1NO.VOICE OUTLET	230
	4NOS.13AMP UNIVERSAL SOCKET (UPS) WITH 1NO.16AMP SWITCH	230
	1NO.16AMP UNIVERSAL SOCKET (RAW) WITH 1NO.16AMP SWITCH	230
	DISTRIBUTION BOARD (LIGHT,POWER & UPS)	1500
	SWITCH BOARD	1050
	CCTV CAMERA	CEILING
	SMOKE DETECTOR BELOW FALSE CEILING	CEILING
	2WATT SPEAKER FOR PA SYSTEM	CEILING
	SMOKE DETECTOR ABOVE FALSE CEILING WITH RI	CEILING
	20A SWITCH SOCKET FOR AC	AS PER SITE
	CEILING FAN	CEILING



SITE LAYOUT PLAN FOR AMRIT PHARMAY AT LADY HARDRINGE MEDICAL COLLEGE

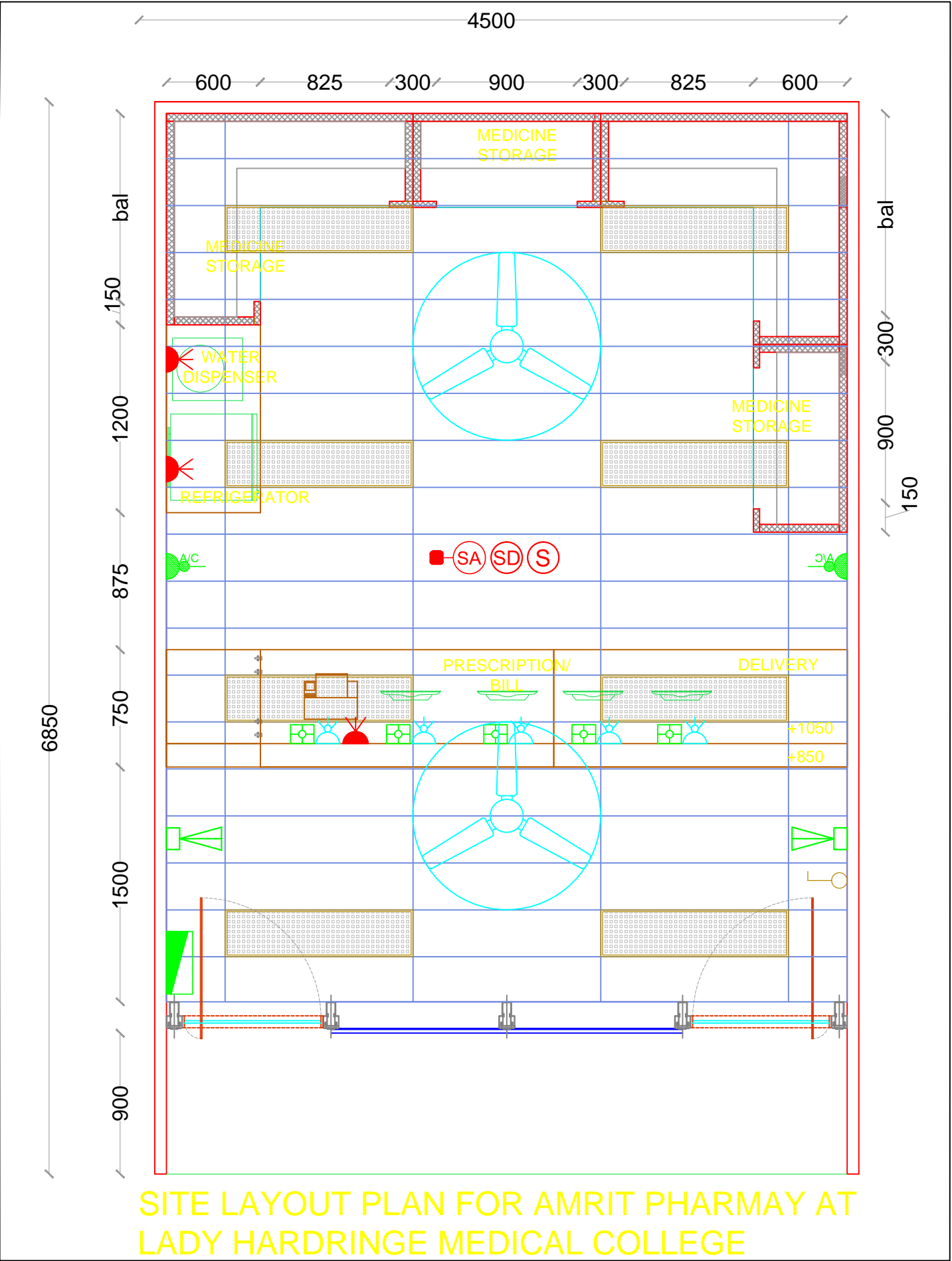
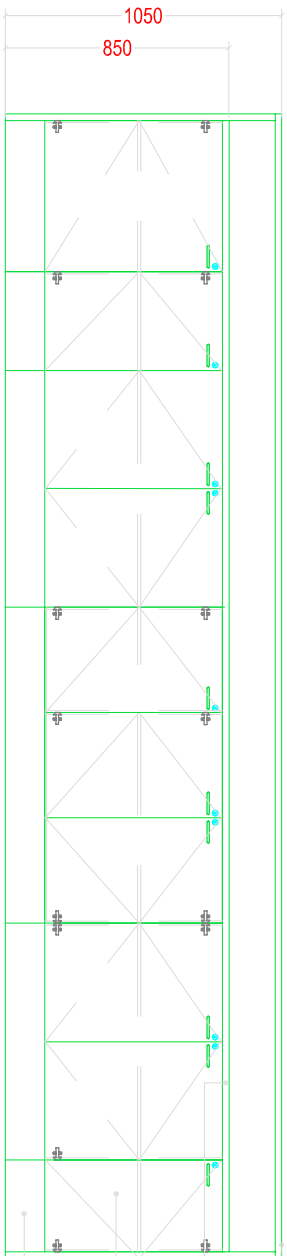

REAR ELEVATION

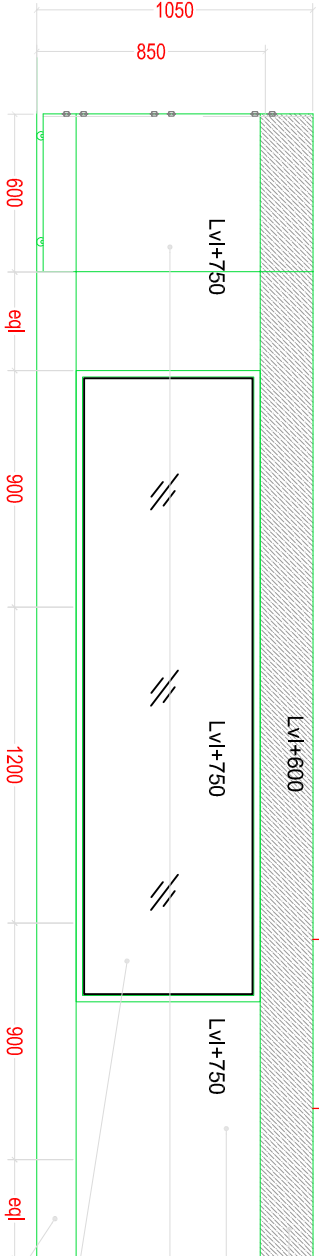

FRONT ELEVATION

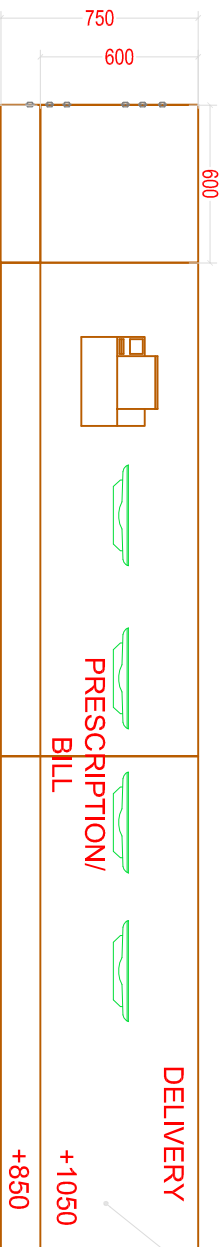

PLAN

As per site

25mm thk top with acrylic(LG Hausys-G019/Eq) finish as/app

25mm thk counter top with laminate(Greenlam-701 Rising beech/Merino / Century/Eq) finish as/app

18mm thk shutter with laminate (Greenlam-701 Rising beech/Merino / Century/Eq) finish as/app

150mm high ss laminated skirting finish as/app

Laminate finish-(Greenlam-173 Barbie pink/Merino / Century/Eq) as/app

Laminate(Greenlam-283 sky blue/Merino / Century/Eq) finish fascia as/app

600mm size movable storage unit with casters as/design

Laminated sliding shutter as/app

Display unit with 8mm glass,25mm beading all around the glass as/design

150mm highSS laminated skirting

Double level Counter of 750mm depth and Counter top at 1050mm level. 12mm thk acrylic sheet to be used for counter top on 25mm thk commercial ply. 12mm thk "L" shaped laminated strip of 150x200 to be fixed with 12mm thk ply at 850mm. Display unit with 8mm thick toughened glass fascia and 18mm thick prelaminated shelves to be inbuilt in counter as/design

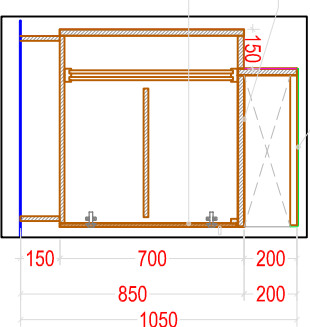

SECTION-X

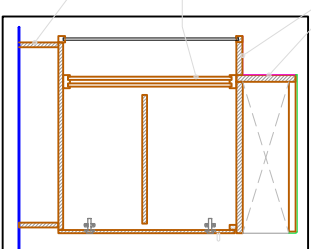

SECTION-X1



DWG NO : P(60)_DD02	REV NO : 01	DMS DESIGNS C-12777, Sustain pk-I, Gurgaon - 122009 Email:info@dmstdesigns.co.in Web: www.dmsdesigns.co.in
DWG TITLE : Reception Counter-LHMC	PROJECT : PROPOSED LAYOUT FOR AMRIT PHARMACY DELHI	REGISTERED THIS DRAWING IS AN ORIGINAL PROPERTY OF DMS DESIGN'S CONSULTANTS PVT. LTD.
Scale : 1:50	Drawn By : JS	
Checked By : JC	DATE : 29.11.16	
Stage : TENDER		

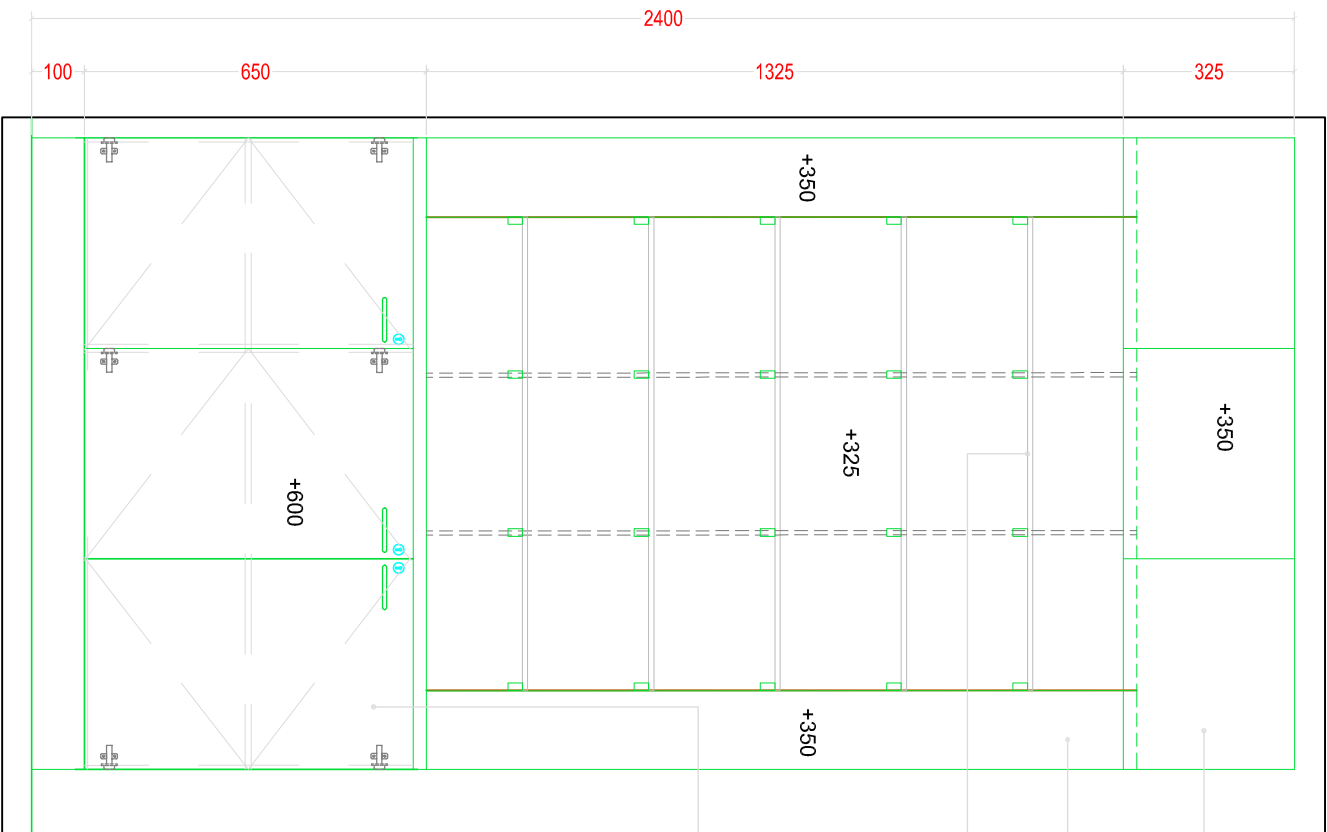

ELEVATION

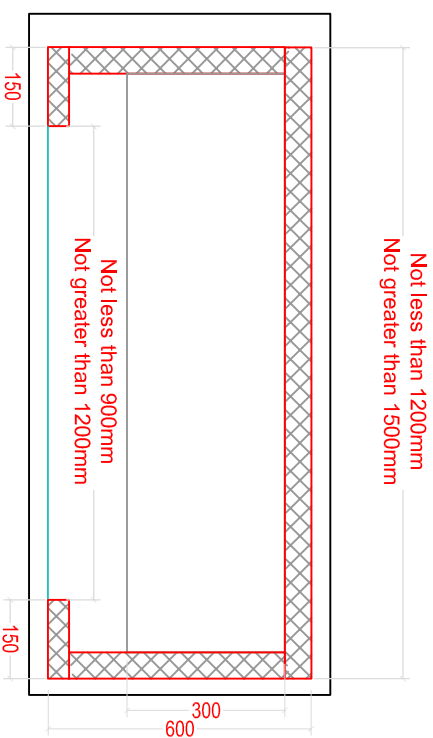

PLAN

- 300mm high, 350mm depth storage with laminate (Greenlam-283 sky blue/Merino / Century/Ed) shutter as/design
- 150mmx350mm size box with laminate(Greenlam-283 sky blue/ Merino / Century/Ed) finish as/design
- 10/12mm tik toughened glass shelves fixed with aluminum channel as/app
- 750mm high 600mm depth storage with shutter finished with laminate (Greenlam-283 sky blue/Merino / Century/Ed) as/app

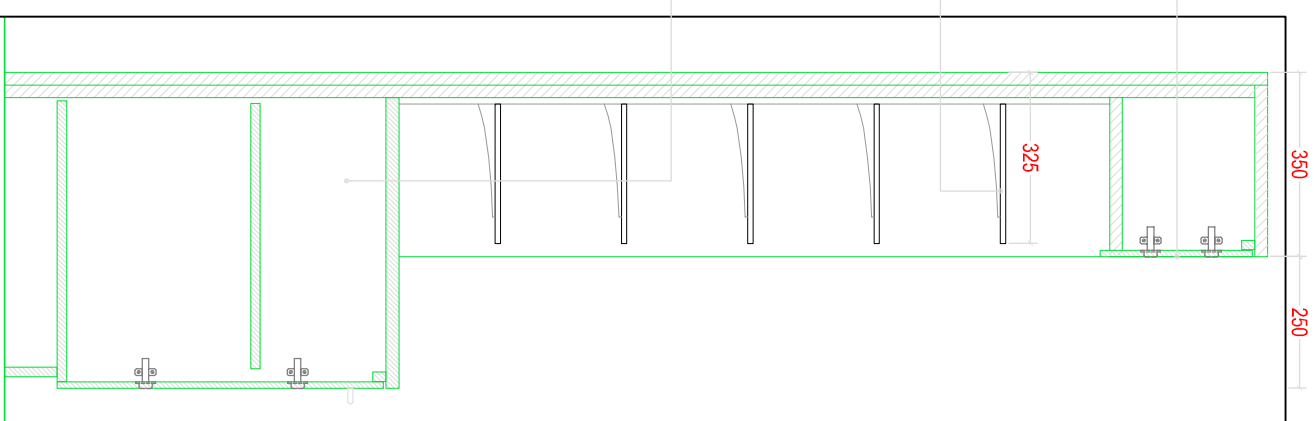

DWG NO : P(60), DD01	REV NO : 01	DMS DESIGNS C-12777, Saurabh pk-I, Gurgaon - 122009 Email: info@dmsdesigns.co.in Web: www.dmsdesigns.co.in
DWG TITLE : Medicine storage-LHMC	PROJECT : PROPOSED LAYOUT OUT FOR AMRITI PHARMACY DELHI	
Scale : 1:50	Checked By : JS	
Drawn By : JS	DATE : 29.01.16	STAGE : TENDER
REGISTERED THE DRAWING IS AN ORIGINAL PROPERTY OF DMS DESIGNS & CONSULTANTS PVT. LTD.		

